

Capsule 0.1

Capsule 0.1

An acoustic booth that consists a perfect solution for **privacy and sound isolation** in open-plan spaces. It is creating an island of silence within open space, with a stylish interior space element for **focused conversations and work sessions**.

A modular design, according to your needs and space limitations, with necessarily **light, fresh air ventilation, power socket and screen** facility.

The CAPSULE is guaranteed to bring an **aesthetic privacy solution** to your space, through a cost-effective solution.



DESIGNING AND INSTALLATION

Apart from being suppliers and manufactures, UNC provide Designing and Installation services.

A specialised team of Acoustic Consultants and an experienced team of Acoustic Materials/systems Installers could carry out an end-to-end service for Acoustic treatment.

PRODUCT AVAILABILITY AND SAMPLES

UNC always have stock of the product and samples of each one of it. Feel free to contact us, in order to setting up a meeting in our showroom.

MATERIAL

BODY COLOR

Colour MDF Veneered

Consistent colour distribution from surface to all the way through. Variety of colours as option enable creation, based on client's willing and project requirements.

COLOURS NOTES

*Boards can present colour variations due to the wood's natural changes of tone and to the use of organic dyes only.

*The tone of the surface may get darker with a finishing applied (varnish, oil, wax).



SPECIFICATIONS



MAINTENANCE

It can be cleaned by using a dust broom, a vacuum cleaner or a hard-wrung cloth.

MATERIAL

ACOUSTIC
LINING COLOR

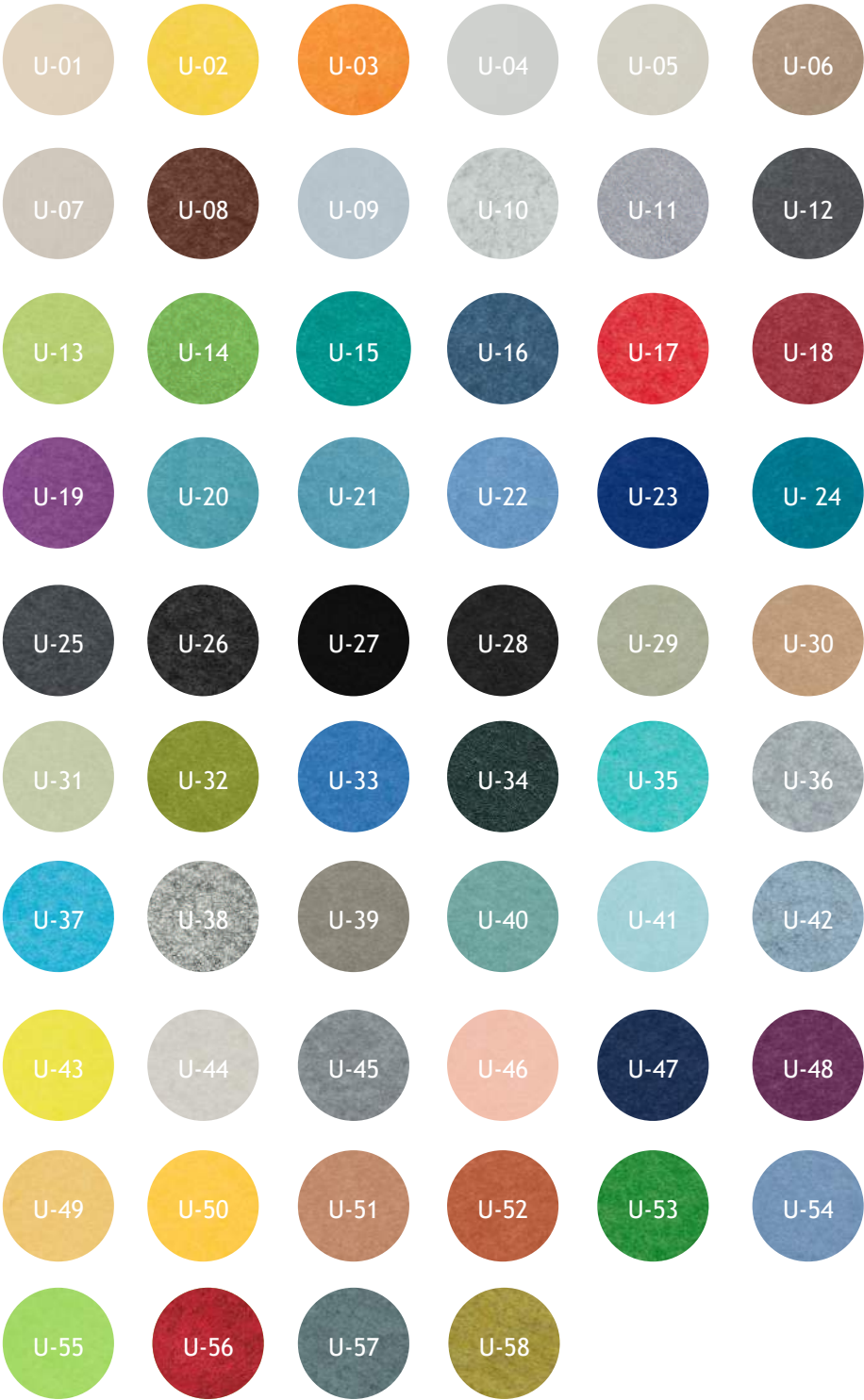



STANDARD DIMENSIONS AND TYPES

Dimensions (LxWxH)

150cm x 100cm x 240cm

Main Materials (Construction Details)

Body: MDF Coloured

Acoustic Lining: 100% PET

Floor: Acoustic Carpet

MDF and PET Specifications:

Flame retardant

Moisture Resistant

Non-Toxic

Non-Added Formaldehyde

Facilities:

LCD panel

LCD monitor

Single power socket for UK plug

Two fans

Four spotlights

Base type:

Levelling machine/pads

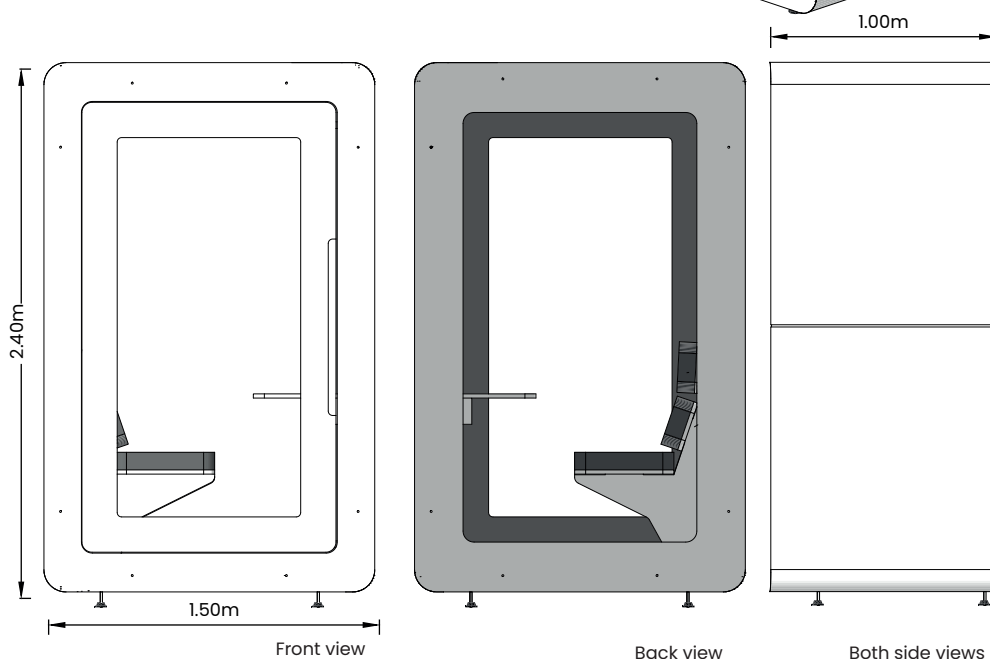
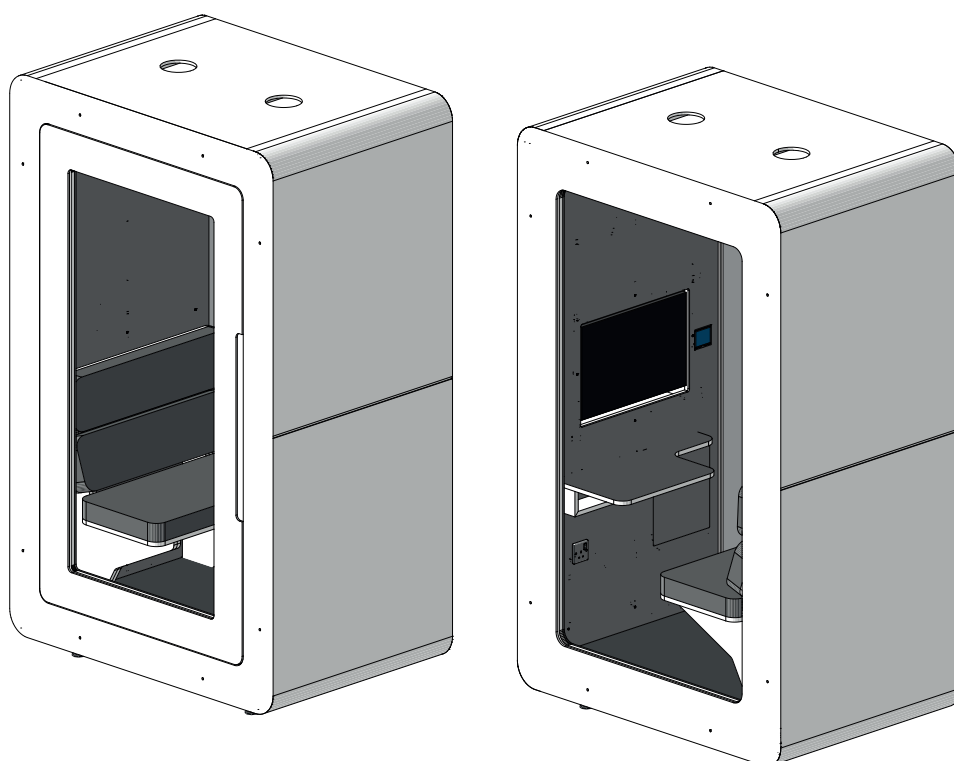



**STANDARD
DIMENSIONS
AND TYPES**

CAPSULE 0.1

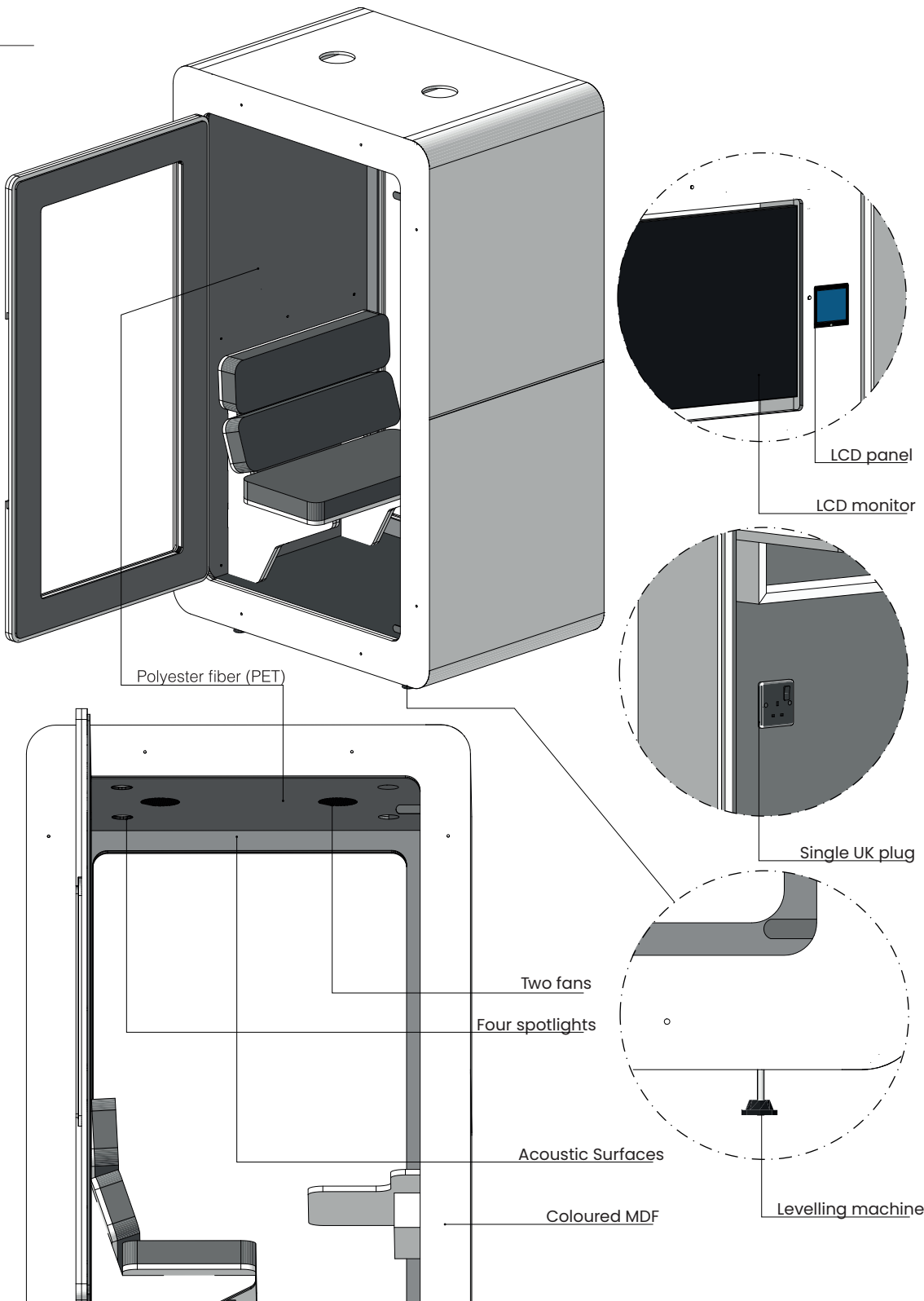

SOUND
INSULATION

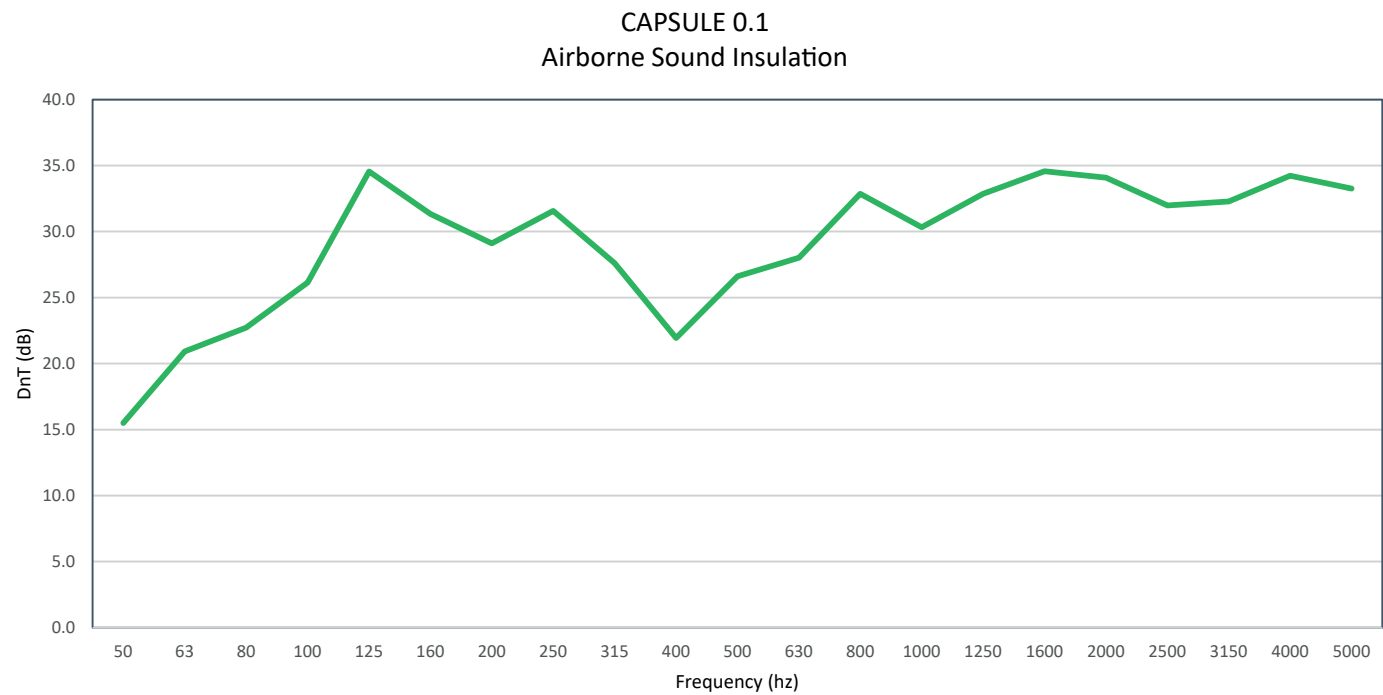

Capsule 0.1
DnT (C;Ctr) 31dB (-1;-2)
[according to ISO 717-1
& ISO 16283-1]

SOUND
INSULATION

Frequency (Hz)	DnT (dB)	
50	15.5	18.6
63	20.9	
80	22.7	
100	26.1	29.3
125	34.5	
160	31.3	
200	29.1	29.1
250	31.6	
315	27.6	
400	21.9	24.7
500	26.6	
630	28.0	
800	32.9	31.8
1000	30.3	
1250	32.9	
1600	34.6	33.4
2000	34.1	
2500	32.0	
3150	32.3	33.2
4000	34.2	
5000	33.3	



Suite No: 238, Al Shafar Investment Building, Sheikh Zayed Road,
Al Quoz, P.O. Box: 212688, Dubai, UAE
www.europhonacoustics.com